

NOTES:

1. MATERIAL: COPPER ALLOY, THICKNESS 0.15±0.01
2. PLATING: AREA(A) 50u" MIN NICKEL UNDER PLATING OVERALL
L: 100u" PURE TIN PLATING ON CONTACT
C: 15u" GOLD ON CONTACT
1: GOLD FLASH (1U"MIN) ON CONTACT
3. COMPONENT LOAD PER REEL: 10K PCS
4. SPEC. PLS. REFER TO PS-50273-XXXX-XXX
5. WIRE RANGE: SUITABLE FOR AWG#28~#32
6. PART NUMBER

51348-T X X X-XXX
 TYPE ——— X — XXX
 O: NONE ——— 001: NONE
 PLATING ——— L: PURE TIN
 C: 15u" GOLD ON CONTACT
 1: GOLD FLASH (1U"MIN) ON CONTACT FOR LEAD FREE
 MATERIAL ——— 1: PHOSPHOR BRONZE

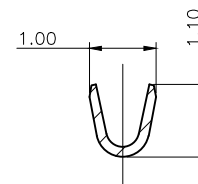
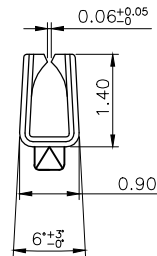
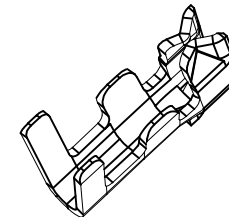

SECTION B-B

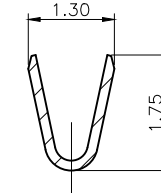

SECTION A-A

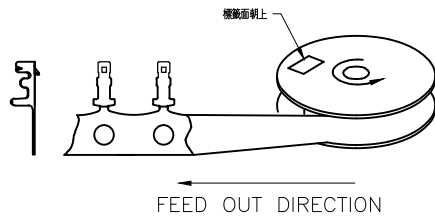

| | | | |
|---|---------------------------|---------------------|----------------------------|
| QUALITY SYMBOLS MAJOR CRITICAL GENERAL TOLERANCES (UNLESS SPECIFIED) X. ±0.5 .X ±0.25 .XX ±0.15 .XXX ±0.1 ANGLES ±2° | DRAWN BY Shi.SongTao | DATE 21/01/25 | |
| | CHECKED BY Xu,ZhiYong | DATE 21/01/25 | |
| | APPROVED BY Xu,ZhiYong | DATE 21/01/25 | DWG NO. N/A |
| | UNITS mm | | SIZE A4 |
| | SCALE 4:1 | SHEET NO. 1 OF 1 | REV D |
| | | | PART NO. 51348-TXXX-XXX |